

# Strainers

## 1/2" - 2" Polypropylene "Y" Strainer



### STANDARD FEATURES:

- Precision molded construction
- Corrosion resistant • Lightweight
- Fiberglass reinforced • Easy grip end cap
- Poly ribbed stainless steel screen
- EPDM gaskets FKM (viton type) available
- Heavy duty end cap threads • 1/2" - 1 1/4" 75 psi max.
- 1 1/2" - 2" 150 psi max.
- Clean-out plug
- Female NPT x female NPT

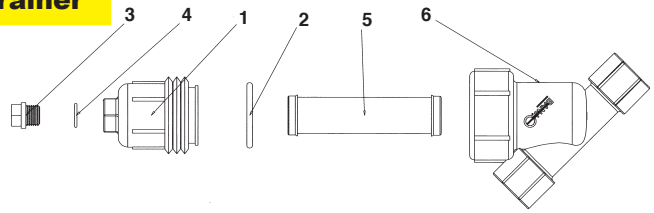

## 1/2" - 1 1/4" "Y" Strainers with SS Screen

DESCRIPTION	PART #
1/2"x1/2" Strainer - 20 mesh SS screen	BALS05020
1/2"x1/2" Strainer - 40 mesh SS screen	BALS05040
1/2"x1/2" Strainer - 80 mesh SS screen	BALS05080
3/4"x3/4" Strainer - 20 mesh SS screen	BALS07520
3/4"x3/4" Strainer - 40 mesh SS screen	BALS07540
3/4"x3/4" Strainer - 80 mesh SS screen	BALS07580
1"x1" Strainer - 20 mesh SS screen	BALS10020
1"x1" Strainer - 40 mesh SS screen	BALS10040
1"x1" Strainer - 80 mesh SS screen	BALS10080
1 1/4"x1 1/4" Strainer - 20 mesh SS screen	BALS12520
1 1/4"x1 1/4" Strainer - 40 mesh SS screen	BALS12540
1 1/4"x1 1/4" Strainer - 80 mesh SS screen	BALS12580

## 1 1/2" - 2" With All Poly Screens

DESCRIPTION	PART #
1 1/2"x1 1/2" Strainer - 12 mesh all poly screen	BALS15012P
1 1/2"x1 1/2" Strainer - 20 mesh all poly screen	BALS15020P
1 1/2"x1 1/2" Strainer - 50 mesh all poly screen	BALS15050P
2"x2" Strainer - 12 mesh all poly screen	BALS20012P
2"x2" Strainer - 20 mesh all poly screen	BALS20020P
2"x2" Strainer - 50 mesh all poly screen	BALS20050P

## 1 1/2" Thru 2" Poly Ribbed with 316 SS Screen

DESCRIPTION	PART #
1 1/2"x1 1/2" Strainer - 6 mesh SS screen	BALS15006
1 1/2"x1 1/2" Strainer - 12 mesh SS screen	BALS15012
1 1/2"x1 1/2" Strainer - 20 mesh SS screen	BALS15020
1 1/2"x1 1/2" Strainer - 30 mesh SS screen	BALS15030
1 1/2"x1 1/2" Strainer - 50 mesh SS screen	BALS15050
1 1/2"x1 1/2" Strainer - 80 mesh SS screen	BALS15080
1 1/2"x1 1/2" Strainer - 120 mesh SS screen	BALS150120
2"x2" Strainer - 6 mesh SS screen	BALS20006
2"x2" Strainer - 8 mesh SS screen	BALS20008
2"x2" Strainer - 12 mesh SS screen	BALS20012
2"x2" Strainer - 20 mesh SS screen	BALS20020
2"x2" Strainer - 30 mesh SS screen	BALS20030
2"x2" Strainer - 50 mesh SS screen	BALS20050
2"x2" Strainer - 80 mesh SS screen	BALS20080
2"x2" Strainer - 120 mesh SS screen	BALS200120

## Replacement Parts 1/2"-2" Poly "Y" Strainer

ITEM	DESCRIPTION	PART #
5	20 mesh screen (fits 1/2"-3/4" strainer)	BALS720
5	40 mesh screen (fits 1/2"-3/4" strainer)	BALS740
5	80 mesh screen (fits 1/2"-3/4" strainer)	BALS780
5	20 mesh screen (fits 1"-1 1/4" strainer)	BALS120
5	40 mesh screen (fits 1"-1 1/4" strainer)	BALS140
5	80 mesh screen (fits 1"-1 1/4" strainer)	BALS180
5	6 mesh screen (fits 1 1/2"-2" strainer)	BALS206
5	8 mesh screen (fits 1 1/2"-2" strainer)	BALS208
5	12 mesh screen (fits 1 1/2"-2" strainer)	BALS212
5	20 mesh screen (fits 1 1/2"-2" strainer)	BALS220
5	30 mesh screen (fits 1 1/2"-2" strainer)	BALS230
5	50 mesh screen (fits 1 1/2"-2" strainer)	BALS250
5	80 mesh screen (fits 1 1/2"-2" strainer)	BALS280
5	120 mesh screen (fits 1 1/2"-2" strainer)	BALS2120
5	12 mesh all poly screen (fits 1 1/2"-2" strainer)	BALS212P
5	20 mesh all poly screen (fits 1 1/2"-2" strainer)	BALS220P
5	50 mesh all poly screen (fits 1 1/2"-2" strainer)	BALS250P
2	Gasket (fits 1/2"-3/4" strainer O-ring)	BALS075G
2	Gasket (fits 1"-1 1/4" strainer O-ring)	BALS100G
2	Gasket (fits 1 1/2"-2" strainer) New style O-ring (thicker)	BALS150G
2	Gasket - FLM (viton type) (fits 1/2"-3/4" strainer)	BALS075GV
2	Gasket - FKM (viton type) (fits 1"-1 1/4" strainer)	BALS100-GV
2	Gasket - FKM (viton type) (fits 1 1/2"-2" strainer) O-ring	BALS150GV
N/A	"Y" body, cap & gasket, 1/2"	BALS050B/C1
N/A	"Y" body, cap & gasket 3/4"	BALS075B/C1
N/A	"Y" body, cap & gasket 1"	BALS100B/C1
N/A	"Y" body, cap & gasket 1 1/4"	BALS125B/C1
N/A	"Y" body, cap & gasket 1 1/2"	BALS150B/C
N/A	"Y" body, & cap & gaskets	BALS200B/C
6	"Y" body, 2"	BALS200B
6	"Y" body 1 1/2"	BALS150B
1	End cap (fits 1/2"-3/4" strainer)	BALS075C1
1	End cap (fits 1"-1 1/4" strainer)	BALS100C1
1	End cap (fits 1 1/2"-2" stainer) New style	BALS150C
3	1/4" Drain plug (fits 1/2" & 3/4" strainers)	BA12723
4	EPDM O-ring for drain plug (fits 1/2" & 3/4")	BA12724
3	1/2" Drain plug (fits 1" & 1 1/4" strainers)	BA12777
4	EPDM O-ring for drain plug (fits 1" & 1 1/4")	BAUV15163
4	FKM (viton type) O-ring for drain plug (fits 1" & 1 1/4")	BAUV15163V
3	1" Drain plug (fits 1 1/2" & 2" strainer)	BALSQ200PL
4	EPDM O-ring for drain plug (fits 1 1/2" & 2")	BALSQ200R
4	FKM (viton type) O-ring for drain plug (fits 1 1/2" & 2")	BALSQ200RV